

NO. 19 (2023)



ARHEOLOGIJA
ARCHAEOLOGY

PRIRODNE NAUK
SCIENCE

ARHEOLOGIJA I
PRIRODNE NAUKE

ARCHAEOLOGY
AND SCIENCE

Institute of Archaeology Belgrade
Center for New Technology

ARCHAEOLOGY AND SCIENCE

19
2023

Belgrade 2023

Arheološki institut Beograd
Centar za nove tehnologije

ARHEOLOGIJA I
PRIRODNE NAUKE
19
2023

Beograd 2023.

Publishers:

Institute of Archaeology Belgrade
Center for New Technology Viminacium
Knez Mihailova 35/IV
11000 Belgrade, Serbia
e-mail: archaeo.sci@viminacium.org.rs
Tel. +381 11 2637191

Editor-in-Chief:

Snežana Golubović

Editors:

Miomir Korać
Snežana Golubović

Editorial Board Members:

Roksana Chowaniec, University of Warsaw, Institute of Archaeology, Warsaw
Eric de Sena, Manhattan College, New York, USA
Natalia Goncharova, Lomonosov Moscow State University, Moscow
Gisela Grupe, Ludwig-Maximilians-Universität, München
Michaela Harbeck, Staatssammlung für Anthropologie und Paläoanatomie, München
Žarko Mijajlović, University of Belgrade, Faculty of Mathematics, Belgrade
Milan Milosavljević, University of Belgrade, Faculty of Electrical Engineering, Belgrade
Dragan Milovanović, University of Belgrade, Faculty of Mining and Geology, Belgrade
Zoran Obradović, Temple University, Philadelphia
Zoran Ognjanović, Mathematical Institute, Belgrade
Slaviša Perić, Institute of Archaeology, Belgrade
Milica Tapavički-Ilić, Institute of Archaeology, Belgrade
Dejan Vučković, University of Belgrade, Faculty of Mining and Geology, Belgrade
Zsolt Zolnai, University of Wisconsin - Madison, Madison
Emilija Nikolić (secretary), Institute of Archaeology, Belgrade

Translation:

Jelena Vitezović

Lecturer:

Dave Calcutt

Graphic design:

Davor Radulj

Print:

Grafika Galeb d.o.o., Niš

Printed in:

100 copies

ISSN (Printed) 1452-7448

ISSN (Online) 2738-1102

Izdavači:
Arheološki institut Beograd
Centar za nove tehnologije Viminacium
Knez Mihailova 35/IV
11000 Beograd, Srbija
e-mail: archaeo.sci@viminacium.org.rs
Tel. +381 11 2637191

Glavni i odgovorni urednik:
Snežana Golubović

Urednici:
Miomir Korać
Snežana Golubović

Članovi uređivačkog odbora:
Roksana Hovanjec, Univerzitet u Varšavi, Arheološki institut, Varšava
Eric de Sena, Menhetn koledž, Njujork, SAD
Natalija Gončarova, Moskovski državni univerzitet Lomonosov, Moskva
Gizela Grupe, Univerzitet Ludvig Maksimilijan, Minhen
Mihaela Harbek, Zbirka za antropologiju i paleoatomiju, Minhen
Žarko Mijajlović, Univerzitet u Beogradu, Matematički fakultet, Beograd
Milan Milosavljević, Univerzitet u Beogradu, Elektrotehnički fakultet, Beograd
Dragan Milovanović, Univerzitet u Beogradu, Rudarsko-geološki fakultet, Beograd
Zoran Obradović, Univerzitet Templ, Filadelfija
Zoran Ognjanović, Matematički institut, Beograd
Slaviša Perić, Arheološki institut, Beograd
Milica Tapavički-Ilić, Arheološki institut, Beograd
Dejan Vučković, Univerzitet u Beogradu, Rudarsko-geološki fakultet, Beograd
Žolt Zolnaj, Univerzitet u Viskonsinu - Medison, Medison
Emilija Nikolić (sekretar), Arheološki institut, Beograd

Prevod:
Jelena Vitezović

Lektor:
Dejv Kalkat

Dizajn i tehničko uređenje:
Davor Radulj

Štampa:
Grafika Galeb d.o.o., Niš

Tiraž:
100 primeraka

ISSN (Printed) 1452-7448
ISSN (Online) 2738-1102

Časopis Arheologija i prirodne nauke je objavljen uz finansijsku podršku Ministarstva nauke, tehnološkog razvoja i inovacija Republike Srbije.

The journal Arheologija i prirodne nauke (Archaeology and Science) is published with the financial support of the Ministry of Science, Technological Development and Innovation of the Republic of Serbia.

*Korice:
Viminacijumski amfiteatar, Konstrukcija 1 -
Spajanje fragmenata zidnog slikarstva
(fotografija: Dragana Gavrilović)*

*Journal cover:
Viminacium amphitheatre, Construction 1 -
Merging fragments of a wall painting
(photo by Dragana Gavrilović)*

CONTENTS / SADRŽAJ

Istraživanja *Research Articles*

- Nikola Gavrilović**
Searching for macrofractures caused by modifying flakes into Mousterian points 9
- Marija Krečković Gavrilović**
Better teeth, better health? The relationship between enamel hypoplasia
and osteological stress markers in EBA population from Northern Serbia 21
- Igor Bjelić**
Reconstruction of the archaeological grid layout in the area of the *forum*
of *Municipium DD* 39
- Nikola Unković, Bratislav Stojiljković, Milica Ljaljević Grbić**
From passion to science: Insight into the history and present state
of pigeon-related artifacts preserved in the Nikola Tesla Museum 57
- Samuel A. Hardy**
Illicit trafficking of cultural objects by forced migrants 71

Pregledi *Review Articles*

- Bojana Plemić, Ljubiša Vasiljević**
Archaeological records as evidence of social differences: The dedicators
of Roman epigraphic monuments in the vicinity of thermal springs in Serbia 97
- Ana Đorić**
The look that can petrify: Ancient spolia with Medusa motif embedded
in sacral buildings on the territory of Serbia 109
- Dragana Gavrilović**
Overview of conservation and restoration approaches to the protection
and presentation of Viminacium wall paintings 129
- Maria Stefanidou**
The challenge of a successful mortar intervention in historical buildings 153
- Vanja Korać, Zoran Davidovac**
Kubernetes as an application management platform 163

Izveštaji

Report Articles

- Maja Gajić - Kvašček, Marija Ljuština, Vojislav Filipović, Ognjen Mladenović, Aleksandar Bulatović, Aleksandar Kapuran, Petar Milojević, Bogdana Milić**
First half of the FLOW project - methods, practices and first results 173
- Dejan Masliković, Tijana Stanković - Pešterac, Natalija Vulikić**
Digital tools – a new era in archaeology 187
- Nenad Lajbenšperger, Dunja Svilar Dujković**
Information system of immovable cultural property as an instrument
for the presentation of the archaeological heritage of Serbia 199
- Vanja Korać, Dragan Prlja, Gordana Gasmi**
European approach to artificial intelligence 209

Prikazi

Book Reviews

Ljubiša Vasiljević

- Slađana Rajković, Julijana Pešić, Mira Ninošević, Smilja Jović, Aleksandra Grgov
i Jelena Radović, *Odelo ne čini čoveka, ali govori o njemu (Odevanje i kićenje u
leskovačkom kraju od praistorije od savremenog doba) / A Suit Does Not Make
a Man, But It Talks About Him (Clothing and Embellishment in the Leskovac Area
from Prehistory to the Modern Time)*, Leskovac 2021 217

Ljubiša Vasiljević

- Teodora Branković, *Konzervirani spomenici iz lapidarijuma antičke zbirke
Narodnog muzeja Požarevac / Conservation of Stone Monuments from Antique
Collection of National Museum of Požarevac*, Požarevac 2022 219

- Uređivačka politika časopisa *Arheologija i prirodne nauke* 221

- Uputstvo autorima o načinu pripreme rukopisa za časopis *Arheologija
i prirodne nauke* 231

- Editorial Policy of the Journal *Arheologija i prirodne nauke*
(*Archaeology and Science*) 237

- Submission Instructions for the Journal *Arheologija i prirodne nauke*
(*Archaeology and Science*) 247

- Spisak autora / List of Authors 253

IGOR BJELIĆ 
Institute of Archaeology
Belgrade, Serbia
E-mail: igor_bjelic@yahoo.com

Received: July 30th 2023
Accepted: September 5th 2023
Research article
UDC: 902.33(497.115)
https://doi.org/10.18485/arhe_apn.2023.19.3

RECONSTRUCTION OF THE ARCHAEOLOGICAL GRID LAYOUT IN THE AREA OF THE *FORUM OF MUNICIPIUM DD*

ABSTRACT

Many years of neglect of certain antique sites in our region can often cause not only their deterioration in the field, but also the misplacing of important parts of documentation linked to their archaeological research. Due to already familiar historical, war-related and political circumstances in the area of Kosovo and Metohija, studies of results of previously conducted archaeological research activities on certain sites are often limited due to the absence or incompleteness of parts of the documentation. Such is the case with the antique site of Municipium DD in the area of today's Sočanica.

On the basis of the preserved part of the documentation (mainly, archaeological journals), we had the possibility of forming a better interpretation of the circumstances in which certain finds were discovered. However, the absence of a part of the technical documentation (plans and drawings) prevented us from gaining, in a well-founded manner, an understanding of the archaeological context as a whole from the very start. One of the largest problems was the lack of a grid layout, according to which the research was organised, and which obviously existed, as can be seen from the archaeological journals. In order to gain a better understanding of the archaeological context, it was necessary to reconstruct its position in the area of the forum of Municipium DD.

KEYWORDS: RECONSTRUCTION OF THE COURSE OF THE ARCHAEOLOGICAL RESEARCH, GRID LAYOUT, METHODOLOGY OF THE ARCHAEOLOGICAL EXCAVATION, ARCHAEOLOGICAL UNITS, *FORUM, MUNICIPIUM DD, SOČANICA*.

INTRODUCTION

In our experience, revisiting the results of research of sites that have not been the subject of research activities (both in the field and as scientific papers) for several decades, or at least recently, often involves the absence of a part of the documentation. This is a particularly common occurrence in the territory of the former SFRY, whose acrimonious disintegration led to fallouts among workers from protection institutions (museums, in the case of mobile findings, and institutes for the protection of monuments, in the case of immovable heritage), most often on a national basis. This resulted in a situation in which one part of the

mobile material and documentation remained at the original location or in competent institutions, while the other was dislocated. In both cases, they would be accessible to one side, while for the other side, access would be, at best, limited.

This difficult situation also affected immovable heritage from Antiquity. In the case of the north of Kosovo and Metohija, while one side is interested in the activities of the prehistoric society, and the other is interested in the activities of the medieval Slavic population, primarily in the spiritual realm, there is usually no mention, unfortunately, of the preservation of the immovable heritage from the Antiquity period in the field. Political events adversely affected the social status of the population

in this part of Kosovo and Metohija, resulting in a situation in which the antique heritage is almost at the bottom of the list of concerns of the local community (Савић 2013).

All these circumstances have had an unfavourable effect on the state of the documentation as well, which has been scattered or lost, thus making it more and more difficult to be traced with the passage of time. One such important antique site is *Municipium DD* (**Figure 1**), about which, apart from a published monograph by Emil Čerškov, there have been no significant studies in the last sixty (!) years that would deal with the results of excavations conducted in the 20th century, aside from general overviews of the Roman presence in Kosovo and Metohija and treatments of minor individual topics (Čerškov 1970; Фидановски 1998; Милин 2002; Гугољ и Тешић-Радовановић 2013; Бјелић и Савић 2020; Ferri 2022).

The published monograph by Emil Čerškov, a pioneer in systematic archaeological research of antique sites in Kosovo and Metohija, deals with the period of research from 1959 to 1965. Although in today's sense, it could be seen with certain shortcomings, for the time in which it was published it represents exceptional content. On a broader scale, the published work by Čerškov must also be seen in the context of the increase in the intensity of scientific research activities, the

number of institutions and personnel dealing with ancient history, and archaeology in post-war Yugoslavia (Mihajlović 2023: 463; Novaković 2021: 164). *Municipium DD* and Ulpiana are the largest antique urban centres in Kosovo and Metohija where extensive archaeological work was carried out with the levels of archaeological methodological practice implemented (Mihajlović 2023, 468-470). Unfortunately, the methodology, as well as the available funding for most archaeological research in that period, often did not sufficiently take into account a larger volume of drawings, detailed descriptions, and measurements in technical documentation that would cover an important segment of the scientific research work (for an analogy on this question see: Đorđević and Karović 2021: 39).

Through the kindness of my colleague Marija Savić from the Institute for Serbian Culture Priština (with a temporary seat in Leposavić), I was informed that a part of the documentation (archaeological journals) from the research of *Municipium DD* existed in the Institute for the Protection of Cultural Monuments of Serbia, (in the following text: IPCMS) Belgrade. Colleagues from this institution kindly sent me scanned black and white copies of the journals, on the basis of which the interpretation of the archaeological context began. It soon became clear that many unknown factors



Figure 1. General view of the archaeological excavations in the area of the *forum* of *Municipium DD* in Sočanica (Documentation of the Institute of Archaeology, Belgrade).

would appear during this process due to the lack of technical documentation.

In the documentation that we received from the IPCMS, there is an important segment missing: the plan of the grid layout according to which the archaeological research in the area of the *forum* of *Municipium DD* was organised, and which the researchers, incidentally, constantly refer to in their archaeological journals. Without them, it would be unclear in which places one should look for a given find, in terms of both mobile archaeological finds, but also those of special types (architectural decorations and epigraphic elements). Also, the layout of the walls of older buildings remained unclear, which were discovered under the foundations of buildings A and C, since older researchers would usually register their location on the basis of cardinal points within a given part of the grid layout. The same problem is also present in the most important building of *Municipium DD* – the Temple of Antinous (**Figure 2**), as it seems that, with the passage of time, and in given journals, it was listed under different names (water tank, temple, room D, room α , room γ , etc). We should

also take into consideration different approaches to archaeological journals by certain researchers, since they would sometimes offer only very summary descriptions; another factor that should be taken into consideration their different handwriting. The reconstruction of the grid layout in the area of the *forum* of the *Municipium DD*, thus, became a painstaking process of seeking individual mentions of given architectural parts of buildings and linking them to the spatial distribution, in the form of a grid layout, in the area of the *forum*. One of the main goals was to connect data and reconstruct entities that had been researched over a long period of several decades ago (a good example of this practice is present in the recent interpretation of the antique remains in the area of the former library in Kosančićev venac, see: Đorđević and Karović 2021: 37-41).

Although it was initially obvious from the archaeological journals that the entire space was divided into smaller segments (squares), without a grid their layout was unclear, as was the system according to which the researchers would assign special markings to these spaces, and the dimen-



Figure 2. View of the remains of the Temple of Antinous (Documentation of the Institute of Archaeology, Belgrade).



Figure 3. Interior of *horreum* C (Documentation of the Institute of Archaeology, Belgrade).

sions of the individual squares. For buildings A and C (western and eastern *horreum*), it was clear from the start that the research was organised into smaller square-shaped areas according to the interior division of space, affected by the regular distance between pillars and pilasters on the walls (**Figure 3**). However, the marking system remained unknown in their case as well. Area B was located between the previously mentioned buildings. Determining the size of the squares and their layout during the marking in this area was completely unclear, since it was observed that the squares were divided into smaller segments (journal of archaeological research (hereinafter: AFJ), from June 14th 1961), and that each square did not have the same number of segments. Additional confusion was introduced by a researcher's note that the dimensions of these squares were not equal (AFJ, June 8th 1961). The same also applied to the most important building of the entire *forum* – the Temple of Antinous. Bearing in mind the fact that this is one of the few pagan temples from the Roman period known in the area of the Central Balkans, it is apparent how much of a problem the lack of knowledge on the

archaeological research context can be in any interpretation of this building.

Aside from the archaeological journals, the posthumously published dissertation of Emil Čerškov, head of the research, was certainly most helpful. The plans from the monograph and the existing situation in the field made it possible to more easily recognise certain parts of the buildings mentioned in the archaeological journals (Čerškov 1970: prilog (attachment) III) (**Figure 4**). The mentioned parts of the buildings represented the basis for the interpretation of the edges of individual squares of the grid layout.

BUILDING A

Building A is characterised by an elongated base with two rows of pillars in its interior. Čerškov identified it as a *horreum* (Čerškov 1970: 15). There is a sequence of pilasters on its walls, whose position is coordinated with those on the opposite walls and with the position of the pillars, thus, the interior space is divided into smaller parts in the shape of squares. By gradually matching and

SOČANICA
MVN.DD.
Forum
R-1:250

PRILOG III

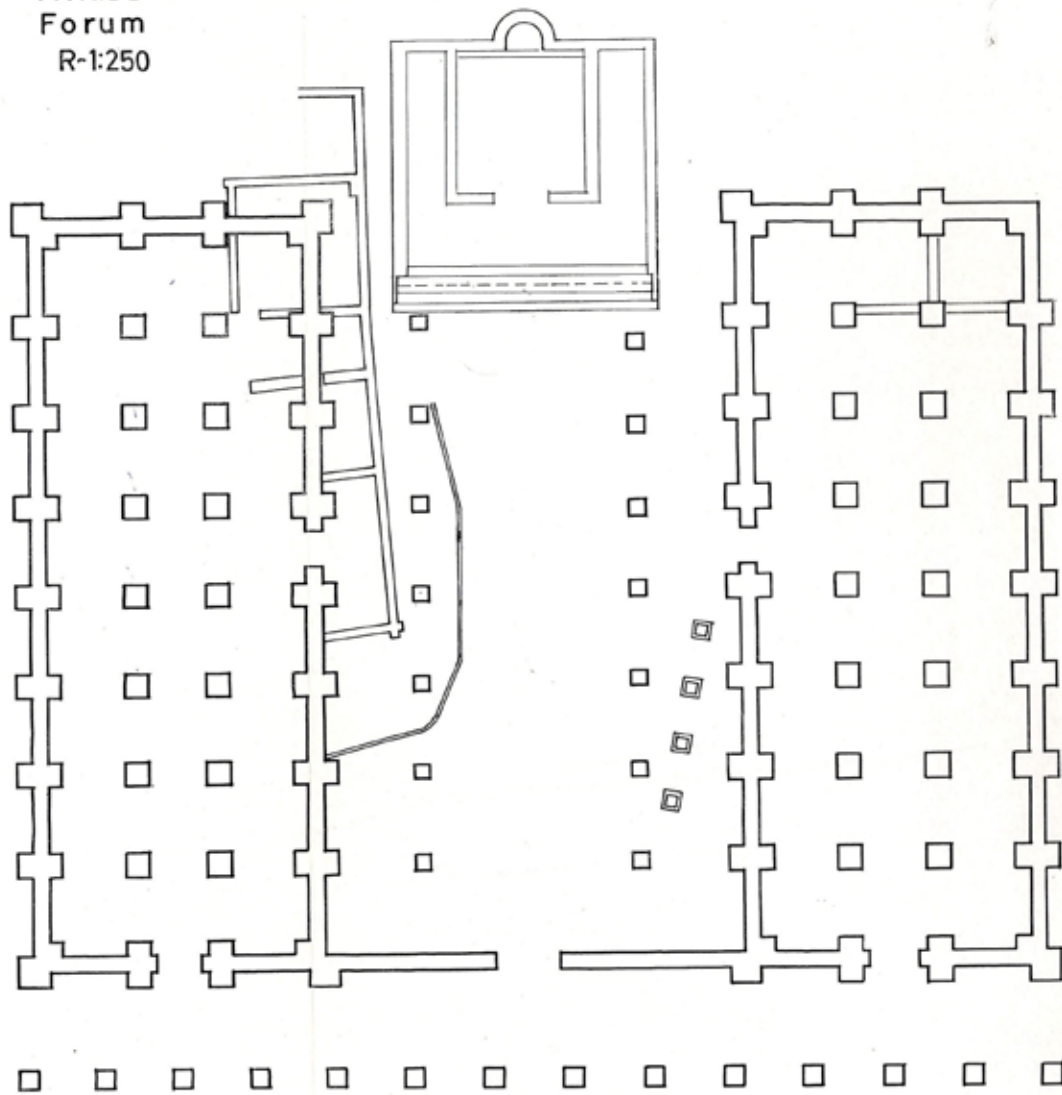

Figure 4. Foundations of the researched constructions in the *forum* of *Municipium DD* (Čerškov 1970, attachment III).

combining data from the archaeological journals, it was possible to determine the position of the squares, pillars and pilasters that were mentioned in the archaeological journals with the indicated markings. The chronological order of the excavations is indicative for their marking; therefore, we will follow this sequence further in this paper.

Systematic archaeological research activities in building A began with excavations in squares 1–3, which are said to have extended along the northern wall 1 (AFJ, August 2nd 1960). For square

3, it was stated that the remains of pillar II, on the opposite side from pilasters 2 and 3 (AFJ, August 3rd 1960), were discovered along the southern profile; those pilasters were connected to the previous ones by more recent walls. Pillars I and II were also connected by a similar wall. The plan published by Čerškov (Čerškov 1970: prilog III) indicates that the mentioned pillars must have been the northernmost in the interior of the building. It was still uncertain from which side the numbering of these pillars was performed and, thus, which

pillar is no. I and which is no. II. Squares 4, 5 and 6 were discovered in the continuation of the works and it was noted that, once they were excavated, all sides of pillars I and II were discovered. At the same time, it was emphasised that pilaster 18 was located on the opposite side from pillar I (AFJ, August 6th 1960).

When it comes to the door on the western wall, it was stated that it was flanked by pilaster 15, but it was not specified whether it was located to the south or north of this door (AFJ, August 6th 1960). In the same building, the entire area of the southern wall 3, where pilaster 11 was located, in the immediate vicinity of the door, was discovered during this year (AFJ, August 3rd 1960). The discovery of the pillars of an older building located under building A is also linked to the same date, while the remains of a more recent wall, standing diagonally in relation to wall 2, were discovered on the following day. A more recent wall was discovered in the area of square 12 (AFJ, August 10th 1960). Comparing this piece of information with the mentioned plan by Čerškov, we reached the conclusion that this square must be one of those in line with the door in the western wall of the building. When it comes to square 24, it is known that it comprehended one of the corners of the interior of the building, but it is not specified which one (AFJ, August 10th 1960).

Archaeological notes from August 11th 1960 made it possible to define individual pillars as corner pillars of certain squares. Thus, pillars V and VII belong to square 10, and pillar VI belongs to square 12. Squares 15, 18 and 21 belong to the same sequence. At this point, the particulars provided were not sufficient for us to be able to define the position of the squares and the pillars, but they did help in locating them with more precision later on.

The marking of the pillars was possible due to the fact that in one of the archaeological journals there was also an accompanying sketch for a part of the space inside the building (AFJ, June 8th 1961) (**Figure 5**). According to this, the third pillar (viewed from the north towards the south, and in the western half of the building) was marked with the number V, while the pillar next to it (in the eastern half) was marked with the number VI. South of pillar V was pillar VII, and south of pillar VI was pillar VIII. Based on this, it was possible

to reconstruct the order in which the pillars were marked and numbered. The first one would have been in the north-western part, and the second pillar in the north-eastern part of the area. Further numbering would have followed the same procedure in each subsequent row, thus, the last registered pillar in the row bore the number XIV and was located in the south-eastern part of the area.

The marking of the pilasters proved to be a more complex task. Let us begin with the data we already knew. Pilaster no. 16 was located to the west of pillar VI, and pilaster no. 15 to the south of it. At this point, it is necessary to bear in mind the fact that pilaster 18 was located across from pillar I; thus, we obtained a clarified sequence of pilasters marked from 15 to 18 on the western wall. It is evident that the marking of the pilasters was performed in a clockwise direction. In doing so, there was one obvious problem, as the first pilaster would be the one to the east of pillar II, which is unusual, as marking would normally start from a pilaster at the corner of the building. Since the journals mention numbers ranging only from 1 to 18, the pilasters on the northern wall would have remained unregistered. Other discrepancies would occur as well. In earlier notes, it was clearly indicated that wall 2 was the one on the eastern side (AFJ, June 14th 1961), with pilasters 6, 7, 8, 9 belonging to this wall (AFJ, June 9th 1961 and AFJ, June 13th 1961, AFJ, June 14th 1961). However, if all the pilasters were marked according to the previous system, this would mean that pilasters 8 and 9 were located on the southern wall 3, suggesting that some pilasters were excluded from this process.

It is somewhat easier to decipher the marking of individual squares inside the building. Square 14 is the first that can be linked to a given pillar, namely, pillar VII (AFJ, June 15th 1961). The determination of the location of square 20 next to pillar XIV is linked to the same date. It was evident that the mentioned pillars form the corners of the mentioned squares. A more specific location can be determined only for square 10, where the western entrance of building A was found (AFJ, June 15th 1961). It belongs to the sequence of squares 7–10–13–16–19–22 (AFJ, June 20th 1961) in the western part of the building. Judging by the quantity and registration of the mentioned squares, it is evident that the said sequence was

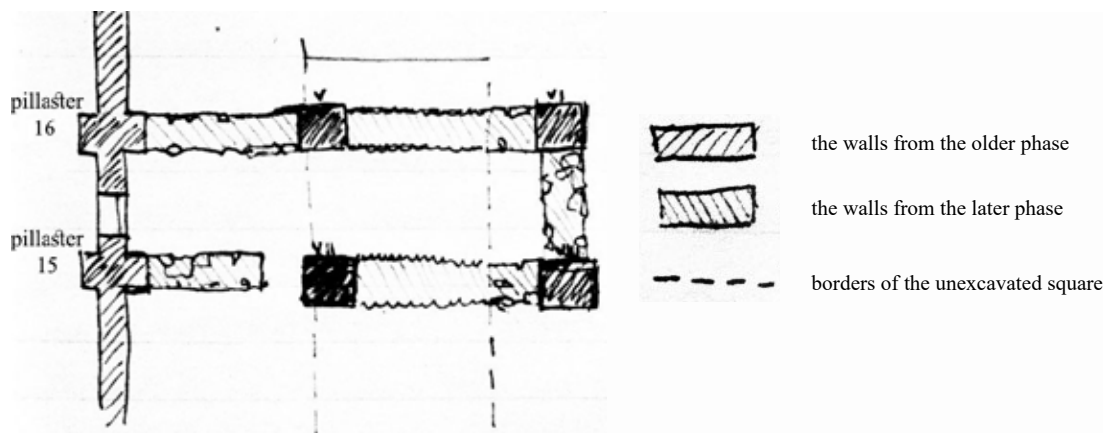

Figure 5. Sketch of the plan with the later phase of the walls between the pillars of the older phase in building A (from one of the archaeological journals kept during the excavations).

placed in a north–south direction. Researchers indicated that squares 8 and 11 were adjacent (same date). According to the notes, the southern door of building A was located in square 23 (AFJ, June 20th 1961). Squares 14, 17 and 20 belong to the second sequence of squares (AFJ, June 21st 1961). Its orientation must be the same as that of the previous one, since none of these squares are listed in the group where the numbering precedes that of the new sequence. The south-western corner of the building belonged to square 22 (AFJ, June 28th 1961), which is in agreement with the previously mentioned sequence of squares in the western third of the building and indicates its correct orientation.

By combining all the previously mentioned data, we were able to reliably reconstruct the marking of the squares. The north-western corner of the area is logically marked with number 1. The marking of the other two squares as carried out from east to west, which was also applied to each subsequent row. Within other rows, the same method of marking was observed, by giving the first square in each subsequent row the number which followed the last one in the previous row (Figure 6).

The clarification of the marking of the pilasters could only be performed after the previously deciphered numbering of the pilasters and squares. At first, it was indicated that pilaster 10 belonged to the southern wall 3 and that it formed one of the flanking elements of the door on this wall (AFJ, June 20th 1961). Let us recall that the same was previously stated for pilaster 11, hence, it is evi-

dent that one pilaster was on one side of the door, and the other on the other side. Also, the registering of the walls matched with the one defined in the previous year. From there, it is clear that wall 2 was the one on the eastern side of building A and that, according to earlier notes, the sequence of pilasters 6–7–8–9 belonged to it. From the previous two pieces of information, it is clear that in the marking of the previously mentioned pilasters, only no. 10 and no. 11 were located on the southern wall 3. Since pilaster 10 was one of those two closest to the door, it became evident that the pilasters at the corners of the building were not marked with numbers. It follows that the numbering of the pilasters started from the northern wall, with only the central pilasters marked with 1 and 2. The pilasters on the eastern wall 2 were marked from the north to the south with numbers from 3 to 9, and the pilasters on the western wall of building A were given numbers from 12 to 18 (Figure 6).

AREA B

Area B is located between buildings A and C, which represent two *horrea*. The first research activities of the borders of area B can be dated to 1960. It was discovered, at that time, that the southern wall of building A (wall 3) extended and formed the southern edge of area B (AFJ, July 29th 1960). At a somewhat later point, the pillars of the southern portico of wall 3 were discovered, in the section south of the south-western pilaster of building A (AFJ, July 30th 1960).

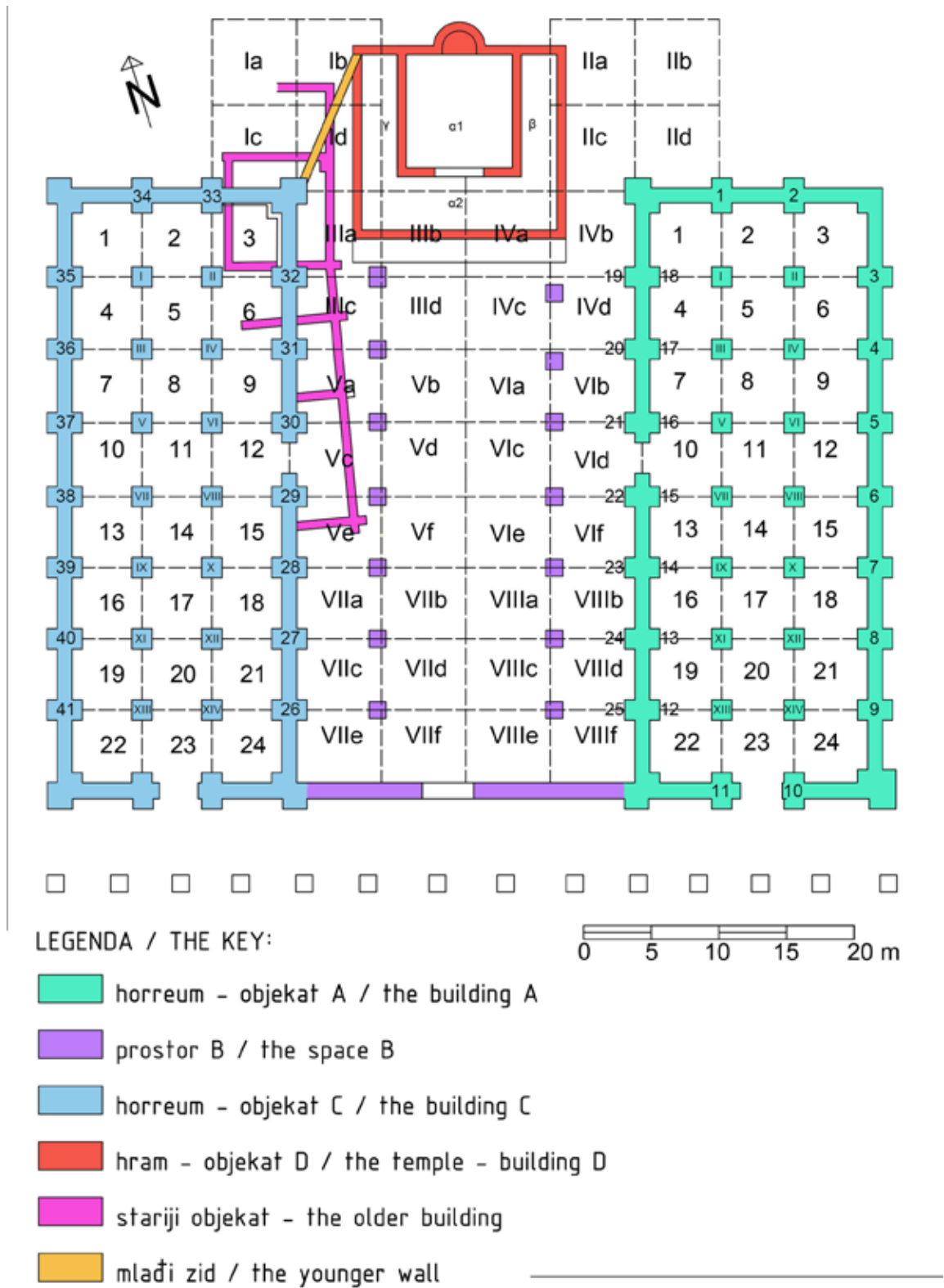

Figure 6. Reconstructed grid layout from the archaeological research of the *forum of Municipium DD* (drawing by the author of the paper).

Area B was divided into squares together with areas north of buildings A and C. Each of the squares was divided into a number of segments. The squares were divided into segments marked with the first letters of the Latin alphabet from a to c (four segments each); however, when it comes to squares VII and VIII, it can be seen that there were more of them, and they were marked from a to f (six segments each).

Unfortunately, due to the lack of a large part of the technical documentation, the dimensions and layout of these squares remain unknown. Let us remember here that the journals recorded that the dimensions of these squares were not identical (AFJ, June 8th 1961), which further complicates matters regarding the previous questions. In order to determine the unknown layout, numbering and dimensions of individual squares in this area, it was necessary to follow the records in the archaeological journals and compare them with the foundations of the buildings, published by Čerškov (Čerškov 1970: prilog III). As with building A, the best way to determine their markings and size was to follow the excavation chronology, combining and matching the data on individual squares whose markings were indicated in the journals.

Most of the archaeological journals from 1961 and 1963 have been preserved, therefore, the chronology of the excavations can be reconstructed in individual fragments from them. During the research in 1961, within area B, squares IIIa, IIIc, IIIId, IVb, IVc, IVd, Va, Vc, Vf, VIb, VIId, VIIf, VIIIb, VIIIc and VIIIf were investigated. As part of the next research period, in 1963, squares Ic, Id, IIIa, IIIc, IVc, Va, Vc, Ve, Vf, VIb, VIId, VIIa, VIIc, VIIe, VIIIc, VIIIe, VIIIId and VIIIId were investigated (**Figure 7**). In 1963, the layout of the extensive walls of the temple and building C, as well as the line of the pillars of its portico (AFJ, June 28th 1963) and the extensive walls of building A were already known. However, there is no mention, in any of the square areas that were opened in 1963, of the pillars of the portico of building C, therefore, it was problematic to link the borders of the squares with these architectural elements on the basis of the journals from this year.

In the journal for 1961, the pilasters on the outer face of the western wall of building A were designated with numbers from 19 to 32, the same as those on the eastern wall for building C. In both

cases, the corner pilasters were not numbered, as we have already pointed out previously. By comparing this numeration of the pilasters on the western wall in 1961 with the one presented in the previous part, we came to the conclusion that an error had obviously occurred and that the pilasters on the western wall had been registered twice. Moreover, every pilaster on all the other walls of building A had the same number on the outside and inside of the wall. The reason obviously lay in the circumstance whereby the works inside building A were headed by one archaeologist, and the works in area B by another, which can also be seen from the journals, by the different handwriting. The aforementioned inconsistency required that the marking of the pilasters on the side of building A facing area B should be deciphered again.

The marking of the squares in area B was carried out with numbers from IV to VIII. Since each of them was characterised by a special size, position and number of segments, we will list the more important elements that helped us locate each individual square and its segments.

For square IVd, it was only stated that it included the discovery of the [foundational – author’s note] base of one of the pilasters. It was not specified exactly to which pilaster this refers, and it is only clear from the context of the research that it belonged to building A. Based on that, it can only be stated that the mentioned square belongs to a sequence of squares stretching along the line of the portico of building A.

Inside square Vf, in the north-western part, a base of a pillar was discovered (AFJ, June 6th 1961), and it was noted that it was “analogous” to the other one in square VIId. Another pillar base was discovered in the south-western part of the same square. Therefore, it is apparent that the mentioned bases represent the corners of trench Vf. In this square, researchers also registered a lead pipe that ran towards the north along the entire length of the square (AFJ, June 21st 1961). Thanks to the plan published in the dissertation by E. Čerškov (Čerškov 1970: prilog III), we know the location of this pipe.

As for square VIId, it was stated that it was bordered [on the eastern side – author’s note] by pilasters on both sides of the door (unfortunately, it does not say what numbers they were marked with). However, the previous piece of information

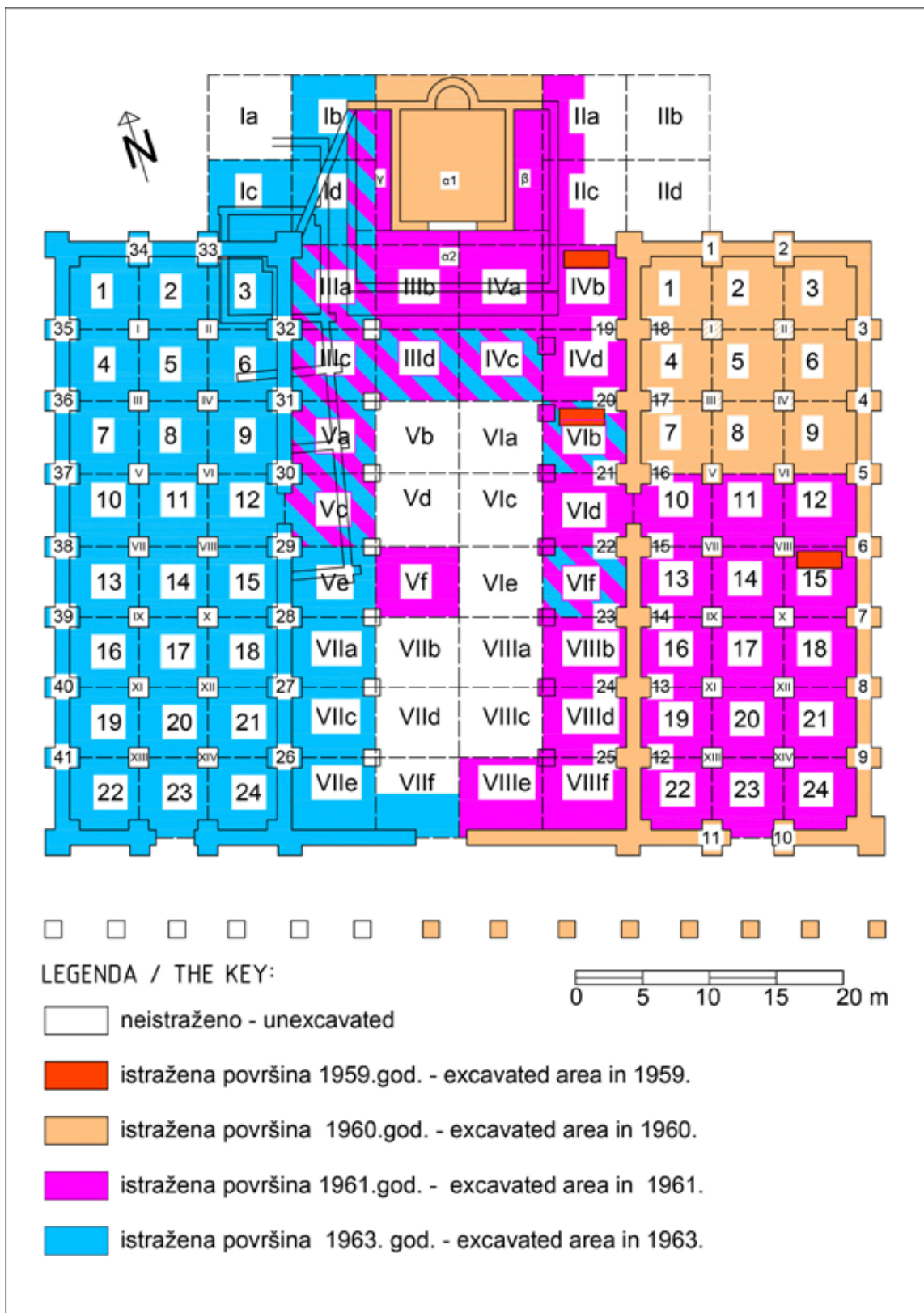

Figure 7. Reconstructed excavation chronology in the area of the *forum* of *Municipium DD* (drawing by the author of the paper).

made it easier for us to define the position of the mentioned square, as well as to define its length in the north–south direction (AFJ, June 17th 1961). Due to its position, it comprehended the entrance door on the western wall of building A, extending from the pilaster south of said door up to the pilaster that was further north of it. When it comes to square VI f, it was stated that it included one of the bases of the portico of building A, and later it was specified that it stood on the opposite side from pilaster 22 on the western wall of the mentioned building (AFJ, June 18th 1961). This piece of information indicates that the mentioned square belongs to a sequence of squares stretching along the line of the portico of building A. Minor excavations were carried out in square VI b in 1963 (AFJ, August 20th 1963).

Pilasters 27, 28 and 29 were placed in the context of square VII, namely, its segments a, c, e (July 13th 1963). However, when it comes to pilaster 29, it is clear that it could not have belonged to the mentioned square because it was quite far from it and, instead, it belonged to squares V c and V e, as we established earlier.

In square VII a, works did not last long (one excavation layer), before being halted, because further exploration of this area interfered with the removal of soil; therefore, nothing more can be said about its position. As for square VII e, it is stated that the south-western corner of area B also belonged to it (AFJ, July 12th 1963), and also that it comprehended at least a part of pilaster 26 (AFJ, July 11th 1963). This piece of information is also confirmed by a note stating that next to the “south-eastern corner pilaster” (the cardinal direction is indicated in relation to building C, to which the pilaster belongs), a larger number of broken bricks appeared along the southern side of the segment – next to the wall (which obviously delimits area B). It follows that square VII e encompassed the south-western corner of area B. It was stated that only half of the surface of square VII f was comprehended in order to reveal the wall. This indicates that no other constructional structures had been previously registered in the area of this segment, which would have required the entire surface to be examined, and only the wall was uncovered, which was also present in the neighbouring segment VII e (July 29th 1963). This is specified in the part where it was stated that

the trench was extended along the southern wall, since the floor level was previously reached in segment VII e (July 30th 1963). The previous statement indicates that square VII f had to be found further east than square VII e, whose position was previously determined.

When it comes to square VIII b, it was stated that its corners on the eastern side were formed by pilasters 23 and 24 of the western wall of building A, while its western corners were formed by two bases of the portico of the same building, at a distance of 1.82 m from the wall (June 15th 1961 and June 17th 1961). This piece of information indicates that the mentioned square belonged to a sequence of squares that stretched along the line of the portico of building A. In 1963, excavations were performed in square VIII, in the area of segments e and f. As for segment VIII f, it was only stated that the situation was the same as in square VII f, where a wall followed along the southern side of the trench (August 30th 1963 – August 31st 1963). Segment f was formed next to the aforementioned wall, as can also be seen from data recorded on July 29th 1963. The aforementioned data indicates that squares VII and VIII were symmetrical and that both extended along the southern wall of area B, the former occupying the western half, and the latter the eastern half. When it comes to square VIII d, it is only stated that a large amount of stone and rubble was removed (AFJ, July 3rd 1963 and July 31st 1963).

Earlier, we pointed out that the base registered in square VI f, according to researchers, was “analogous” to the one in square VI f (AFJ, June 20th 1961). This indicates that squares V and VI were placed on opposite sides to each other, hence, the bases excavated in them were symmetrical. In that case, square VI would be analogous to square V, and square VII would be analogous to the square marked with the number VIII. When it comes to the last-mentioned squares, we should bear in mind, to begin with, that those were the only squares divided into a larger number of segments (marked from a to f) during the research, confirming the thesis regarding the symmetry of the positions and dimensions of the mentioned squares. At the same time, this observation indicates that area B was divided into squares marked with odd numbers on the western side, and even on the eastern side. However, we can also identi-

fy the marking of the segments of these squares. The squares were divided into smaller segments along the directions north–south and east–west. The first segment of each square (north-west) is marked with the letter a (see square VII in this part), and the second (north-east) with the letter b (which can be seen in the case of segment VIIIb). The south-easternmost segment was marked with the last letter available, which differed depending on the number of segments into which the square was divided. In squares V and VI, such a segment was marked with the letter d, while in squares VII and VIII – with the letter f. The borders of the segments on the line of the porticos of buildings A and C were determined by the position of the portico bases and pilasters on their walls (**Figure 6**).

The aforementioned spatial division of squares into smaller segments is also confirmed by the division present in the area of the older building discovered under building C, which will be discussed further in the text.

BUILDING C

Building C is characterised by a spatial and structural distribution symmetrical to that of building A. However, precisely because of the aforementioned symmetry, it was not clear how the numbering of individual squares, pillars and pilasters was carried out. Therefore, in order to secure the reliability of the interpreted data, the deciphering of the marking of its spatial and structural elements had to be carried out independently of that previously done for building A, located to the east of building C.

On the northern side of this building, one can initially single out squares, pilasters and pillars whose designations can be easily determined according to their position (relative to the cardinal directions) recorded in the archaeological journals. In square 3, the eastern and northern walls are registered (AFJ, July 17th 1963), therefore, it is clear that it comprehended the area of the north-eastern corner of the interior of building C. The north-eastern corner is not marked, which was a practice used in the marking of building A as well. The adjacent corner of this square is formed by pilaster 33 on the northern wall (AFJ, July 31st 1963). From certain notes, it can be concluded that pilaster 34 was to the west of it, also

on the northern wall (these pilasters together were listed as belonging to the said wall), and a little further to the west was the north-western corner pilaster (AFJ, July 31st 1963). From these statements, it was possible to determine the direction of the numbering of the pilasters on the walls of the building. Therefore, the pilaster that preceded the north-eastern corner pilaster on the eastern wall must have been pilaster 32. It was stated that opposite to pilaster 32, in the interior of the building, was pillar II, and on the opposite side, pillar IV (AFJ, August 12th 1963); thus, it can be concluded that the marking of pillars inside building C was carried out in exactly the same way as in building A (repeated as an identical duplicate of the arrangement, without symmetry reflected across the axis of the *forum*).

The archaeological journals also mention another important piece of information, namely, that the door through which building C communicated with area B was located in square 12, and that pilaster 29 was immediately next to the door (AFJ, July 16th 1963).

Square 10 abutted the western wall, and the context of an archaeological note indicated that one corner of its square was formed by pilaster 37 (AFJ, July 21st 1963). Square 13 and pilaster 39 abutted the western wall (AFJ, July 19th 1963). Squares 19 (AFJ, July 19th 1963) and 22 (AFJ, July 19th 1963) abutted the same wall. Therefore, squares 10, 13, 19 and 22 form a sequence that, according to their numbers, can be oriented in a north–south direction, abutting, at the same time, on the western wall.

It is stated that square 24 abutted the eastern wall of the building (AFJ, July 13th 1963), but also the southern and the western wall (AFJ, July 15th 1963). It is, therefore, obvious that there was an error in the notes, because due to the nature of the division of the interior space the square could not have abutted both the eastern and western wall at the same time. We get some clarification in the part where it was stated that square 24 abutted square 21 (AFJ, August 15th 1963); it was previously stated that it abutted the eastern wall of building C (AFJ, July 16th 1963). From there, it becomes clear that square 24 comprehended the south-eastern corner of the building.

By taking into account the position of squares 3 and 24, it becomes clear that the specified se-

quence of squares 10–13–19–22 in the western third of the building, according to this order, can only be oriented in a north to the south direction. At the same time, squares 3, 12, 21 and 24 belong to the sequence that abutted the eastern wall of building C. By comparing the markings of the squares in the previous two groups, it is noticeable that squares 22 and 24 were separated by the one square that could only be found in the central row, to which the door on the southern wall of the building would belong as well. At the same time, the squares on the northernmost side (along the northern wall) were marked with numbers from 1 to 3. By combining all the data on the square numbering of building C and comparing it with that of building A, we can see that they are the same.

At the same time, it becomes apparent that squares 10 and 13 are adjacent, so their previously mentioned corner pilasters 37 and 39 had to have been separated by the segment of the western wall with pilaster 38 in the middle of it. The mentioned direction and order of numbering are in agreement with the one already defined (taking into account the fact that the corner pilasters were not included in the numeration), which is only a confirmation of the correctness of the previous grid layout reconstruction procedure (**Figure 6**).

OLDER BUILDING UNDER BUILDING C

During the research of building C, near pilaster 33, a lower, older wall was registered, which, according to researchers, turned towards the east, forming a rectangular room, 1.50 m from the northern wall of the mentioned building (AFJ, July 31st 1963). Thus, it became clear that the foundations of an older building were located under the remains of building C.

The area of squares Ic and Id was opened to reveal the western wall of the temple and the more recent wall, going from the north-western corner of the temple to the north-eastern corner pilaster of building C. The intention of the researchers was also to determine the shape of the *praefurnium* discovered along the northern wall of the older building under building C. According to the researchers, the borders of the dugout were the mentioned wall of the temple, the more recent wall

that connected the mentioned corner of the temple and the corner of building C, and the eastern half of wall 5 (AFJ, August 20th 1963). Therefore, wall 5 actually represented the northern wall of the older building.

In the area of square IIIa, it was noted that the wall of the older building “still continues (in relation to squares IIIc, Va, Vc, Ve, where it was previously discovered), but now changes its direction slightly, becoming parallel to the wall of the temple” (AFJ, August 29th 1963). Judging by the mentioned context, it would seem that the breaking point of the wall belongs, at least partially, to this square. As for square IIIc, it was stated that “a smaller chamber was formed in this segment with two opposite walls” (August 29th 1963) (**Figure 6**).

In the part of the journal where the situation in the area of square Va was considered, it was indicated that more shallow pilasters appeared in places where the interior of the building was divided into smaller chambers. This circumstance introduces confusion because it is not clear whether these pilasters were located in the area of square Va or, as previously stated, in the area of square IIIc (adjacent to the former one) (AFJ, August 29th 1963) or in both of these squares. For the same segment, it was stated that the surface of the wall of the older building, which also extended through “square Ve”, appeared in the middle of the square (AFJ, August 28th 1963). This piece of information makes it easier for us to determine the length of the mentioned squares in the east–west direction. It was approximately twice as long as the distance of this wall from the eastern wall of building C. The specified length also fits with the previously defined axis in the north–south direction that divides squares III, V and VII into segments, and which coincides with the line of the axis of the pillars of the eastern portico of building C.

TEMPLE OF ANTINOUS (BUILDING D)

One of the major problems when citing certain archaeological discoveries in the area of the Temple of Antinous is the fact that their finding place was not precisely stated in the archaeological journals. That is why it is important to follow the chronology of the excavations along with the

area where they were conducted in a given period within the temple.

According to the notes in the archaeological journals from 1960, the first traces of the temple were found at the location of its northern wall (AFJ, July 23rd 1960). From this side to the south, the eastern and the western walls of the *cella* were excavated. The finding of a mortar floor is also linked to the same date, therefore, it is apparent that a part of the preserved floor was located next to the northern wall of the building. It is obvious that excavations were performed in the area of the *cella* (the central chamber of the temple) in the following days in order to reach the southern wall, but this goal was not reached until July 26th 1960. Segments of the floor continued to be found, which indicates that a part of the floor also extended through the central part of the *cella* (AFJ, July 25th 1960). The works on the northern wall of the *cella* were not finished, since from July 30th to August 3rd of the same year, the apse of the temple was discovered. It is very important to note that it was not until August 4th 1960 that the conclusion was reached that the northern wall continued to extend towards the east, leading, in turn, to the conclusion that only a part of the northern wall of the temple's *cella* was investigated in the previous period.

During 1961, a significant discovery occurred, namely, that of the stairs on the southern side of the building (they were excavated in squares IIIb, Iva and IVb). The first instance of determining the staircase occurred in the western part of square IVb, and, within the same square, the appearance of the eastern edge of this construction was registered (AFJ, June 26th 1961). It was also stated that the steps extend from square IVb, through IVa, further west (AFJ, June 27th 1961). During the next two days, it became clear that the previously investigated area of the *cella*, and the eastern wall of the eastern portico, together with the stairs, form one room, separated from area B and treated as a separate building D (according to AFJ, starting from August 29th 1961). The spatial layout of the squares on the southern part of the temple area was indicated by an archaeological note, dated August 30th 1961, where it was said that it was divided into 4 parts, according to the internal layout delimited by the walls, and that the distribution included the previous squares I and II, IIIa and IIIb, IVa and IVb.

From the same note, it becomes apparent that these parts were labelled with letters of the Greek alphabet. Also, space α was divided into two parts, $\alpha 1$ and $\alpha 2$, while spaces β and γ represent separate spatial units. For the last two areas, it was indicated that they were "analogous" to each other (AFJ, July 1st 1961). The only two spaces that could have had these features are the western and eastern porticos. The identification of space γ is aided by the note that "a slanting transverse wall cut through and destroyed the upper part of the western wall of space γ ", which was obviously the more recent wall, extending from the north-western corner of the temple's portico to the north-eastern pilaster of building C. The identification of space $\alpha 1$ was indicated by the researchers' note that there were remnants of a brick floor on d152, which determined the level of the central space of the temple (AFJ, July 10th 1961). This finally determined the distribution of the researched area of the Temple of Antinous (**Figure 6**).

CONCLUSION

War-related, political and historical circumstances have contributed to a situation in which a large amount of data from the excavations of *Municipium* DD near Sočanica was lost, a part of the technical documentation included. Such was the case with the grid layout that the researchers constantly refer to in archaeological journals, and in the absence of which it is impossible to comprehend the context of any archaeological find. By analysing data from archaeological journals and the dissertation by Emil Čerškov, we have managed to decipher the numeration of the spatial, architectural and construction elements of the *forum* of this settlement. The topic of the marking of the squares with the use of a grid layout was particularly tackled, as well as the marking of the pilasters and the pillars.

During the deciphering of the numeration of the spatial and structural elements of each building, an individual approach was used. This approach had to be chosen because the grid did not always have a standardised or systematised marking system within each of the individual buildings and adjacent spaces (area B, the space inside the temple and the space north of the *horreum*). Thus, the squares inside buildings A and C were num-

bered with Arabic numerals, those inside area B with Roman numerals, while individual segments inside the temple were marked with letters of the Greek alphabet. The combination of these markings, without a restored grid layout, made it difficult for today's researcher to navigate through the archaeological journals.

Our analytical procedure for each individual building turned out to be the correct approach because in the case of buildings A and C, which are symmetrical to each other in relation to the axis of the *forum* rather than exact duplicates, an expected symmetrical numbering of their spatial and structural elements was not carried out by older researchers, instead, it was repeated in the same way in both buildings. A particularly demanding deciphering task was encountered in the case of area B, where the number of squares and their sizes differ, as well as the number of segments into which they were additionally divided. Errors were also observed during the numbering of certain building elements (pilasters on the western side of building A and the description of the borders of square 24 in building C), which were clarified by our analysis.

The analysis also determined the time period in which individual trenches were excavated. The positions of individual test trenches from 1959 have been reconstructed (although there are no preserved archaeological journals about these investigations), which preceded the systematic investigations in the later period. The interpretation of the chronology of the excavations will also contribute to a more precise understanding of the place where certain archaeological finds and architectural remains were discovered, both during the entire excavation period but also during an individual year. Such an interpretation has already brought results regarding the clarification of the finding place of certain architectural remains of the Temple of Antinous and the civilian basilica.

ACKNOWLEDGEMENTS

Documentation from the Institute for the Protection of Cultural Monuments of Serbia, Belgrade, and the Institute of Archaeology, Belgrade, linked to the site of *Municipium DD*, was used in the writing of this paper.

BIBLIOGRAPHY

Бјелић, И. и Савић, М. 2020

Архитектонска скулптована декорација цивилне базилике у античком Муниципијуму DD, *Баштина* 30(52): 387–406.

(Bjelić, I. i Savić, M. 2020

Arhitektonska skulptovana dekoracija civilne bazilike u antičkom Municipijumu DD, *Baština* 30(52): 387–406).

Ђорђевић, М. и Каровић, Г. 2021

Singidunum u temeljima narodne biblioteke na Kosančićevom vencu, Београд: РЗЗСК.

(Đorđević, M. i Karović, G. 2021

Singidunum u temeljima narodne biblioteke na Kosančićevom vencu, Београд: РЗЗСК).

Гугољ, Б. и Тешић-Радовановић, Д. 2013

О пореклу Антинојевог култа у римском насељу код Сочанице, *Зборник радова Филозофског факултета у Приштини* 43(2): 427–444.

(Gugolj, B. i Tešić-Radovanović D. 2013

О пореклу Antinojevog kulta u rimskom naselju kod Sočanice, *Zbornik radova Filozofskog fakulteta u Prištini* 43(2): 427–444.).

Михајловић, В. 2023

Rimsko nasleđe u Srbiji, Нови Сад: Наука, просвета и јавност.

Милин, М. 2002

Новооткривени римски епиграфски споменици из Сочанице (Косово), *Старинар LII*: 163–174.

(Milin, M. 2002

Novootkriveni rimski epigrafski spomenici iz Sočanice (Kosovo), *Starinar LII*: 163–174).

Новаковић, Р. 2021.

The History of Archaeology in Western Balkans, Лjubljana: Ljubljana University Press, Faculty of Arts.

Савић, М. 2013

Презентација и популаризација римског града *Municipium DD* (Муниципијум Дарданорум) код Сочанице, *Баштина* 35: 107–114.

(Savić, M. 2013

Prezentacija i popularizacija rimskog grada Mu-

nicipium DD (Municipijum Dardano-rum) kod Sočanice, *Baština* 35: 107–114).

Фидановски, С. 1998

Римски и рановизантијски период, у: *Археолошко благо Косова и Метохије*, Н. Тасић (ур.), Београд: Галерија Српске академије наука и уметности, 258–349.

(Fidanovski, S. 1998.

Rimski i ranovizantijski period, u: *Arheološko blago Kosova i Metohije*, N. Tasić (ur.), Beograd: Galerija Srpske akademije nauka i umetnosti, Beograd, 258–349).

Čerškov, E. 1970

Municipium DD, Priština: Muzej Kosova, Beograd: Arheološko društvo Jugoslavije.

Ferri, N. 2022

Percorso della strada antica Municipium DD – municipium sconosciuto nella regione di Peja/Peć: Sulla base di reperti archeologici, in: *Book of Abstracts: 6th International Conference on the Roman Danubian Provinces - Roman Roads and Crossroads, Belgrade and Viminacium, 1st – 5th November 2020*, 20.

REZIME

RESTITUCIJA KVADRATNE MREŽE NA PROSTORU FORUMA MUNICIPIJUMA DD

KLJUČNE REČI: REKONSTRUKCIJA TOKA ARHEOLOŠKIH ISTRAŽIVANJA, KVADRATNA MREŽA, METODOLOGIJA U ARHEOLOŠKIM ISTRAŽIVANJIMA, ARHEOLOŠKE CELINE, *FORUM, MUNICIPIUM DD, SOČANICA*.

Poznate istorijske, ratne i političke okolnosti doprinele su da ostaci Municipijuma DD, jednog od antičkih naselja na prostoru severa Kosova i Metohije, budu zanemareni duže vremena, što je praćeno i nedostatkom određenog dela dokumentacije sa istraživanja. Ovakav problem vodi ka neminovnom nerazumevanju arheološkog konteksta u kome se došlo do pronalaska određenih arheoloških nalaza. Najveći problem po pitanju ovog lokaliteta odnosio se na nedostatak kvadratne mreže, prema kojoj su arheološka istraživanja bila

organizovana, a koja je prema sačuvanim arheološkim dnevnicima očigledno postojala. Kako bi se mnogo bolje razumeo arheološki kontekst, neophodno je bilo restituovati njene pravce na prostoru foruma Municipijuma DD.

Kvadratna mreža nije uvek imala standardizovano ili sistematizovano označavanje unutar svakog pojedinačnog objekta i njemu susednih prostora. Kvadrati u objektima A i C numerisani su arapskim brojevima, na prostoru B rimskim, dok su unutar hrama njegovi pojedinačni prostori imenovani slovima grčkog alfabeta. Za današnjeg istraživača, bez raspoložive restituovane kvadratne mreže, kombinovanje navedenih oznaka otežava snalaženje u arheološkim dnevnicima. Odgonetanju nabiranja prostornih i konstruktivnih elemenata svakog objekta pristupljeno je zato pojedinačno. Ovakav postupak analize pokazao se ispravnim kod objekata A i C, koji su u odnosu na osu foruma inače simetrični jedan drugom, ali u isto vreme nije izvedena simetrična numeracija njihovih prostornih i konstruktivnih elemenata, već identična. Uočene su i greške prilikom numeracije pojedinih elemenata građevina koje su našom analizom razjašnjene (kod pilastera građevine A i opis kvadrata 24 u građevini C). Naročito zahtevno odgonetanje nabiranja bilo je na prostoru B čiji se broj kvadrata i njihove veličine razlikuju, kao i broj segmenata na koji je svaki od njih dodatno podeljen.

Našom analizom razjašnjeno je i u kom vremenskom periodu su izvedene pojedine sonde. Tumačenje hronologije iskopavanja doprineće i preciznijem tumačenju mesta na kome su pronađeni pojedini arheološki nalazi i arhitektonski ostaci, kako u toku celog procesa istraživanja, tako i tokom samo jedne kampanje u kalendarskoj godini.

* * *

Copyright: © 2023 Institute of Archaeology, Belgrade. Published by Arheologija i prirodne nauke / Archaeology and Science (<http://viminacium.org.rs/e-biblioteka/arheologija-i-prirodne-nauke/>; <http://viminacium.org.rs/en/e-biblioteka/archaeology-and-science/>).



This article is an open access article distributed under the terms and conditions of the Creative

Commons Attribution license CC BY-NC-ND 4.0 DEED (<https://creativecommons.org/licenses/by-nc-nd/4.0/deed.sr-latn>; <https://creativecommons.org/licenses/by-nc-nd/4.0/deed.en>).

CIP - Katalogizacija u publikaciji
Narodna biblioteka Srbije, Beograd

902/904

ARHEOLOGIJA i prirodne nauke =

Archaeology and Science / glavni i odgovorni urednik
Snežana Golubović. - 2006, No. 1- . - Beograd :
Arheološki institut : Centar za nove tehnologije
Viminacium, 2006- (Niš : Grafika Galeb). - 28 cm

Godišnje. - Tekst na engl. jeziku. - Drugo izdanje
na drugom medijumu: Arheologija i prirodne nauke
(Online) = ISSN 2738-1102
ISSN 1452-7448 = Arheologija i prirodne nauke
COBISS.SR-ID 136747788

